

MOUNTING STYLES

FTM / FSM / FTMR / FSMR
MTM / MSM / MTMR / MSMR

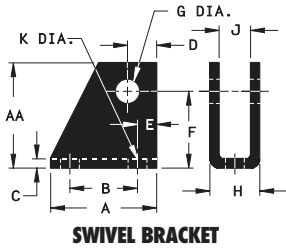

Bore Size	Number
1/2, 3/4	6/4-34
1 1/8	9-34

Connecting pin included.

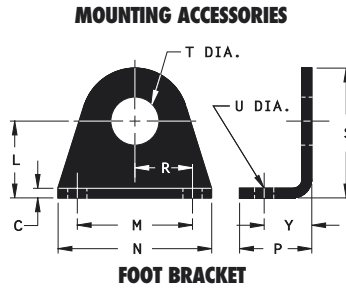

Bore Size	Number
1/2, 3/4	6/4-32
1 1/8	9-32

Mounting nut included.

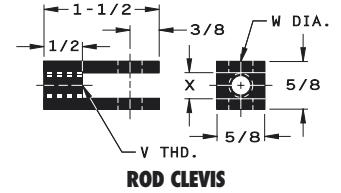

Bore Size	Number
1/2, 3/4	6/4-35
1 1/8	9-35

Connecting pin included.

Bore Size	A	AA	B	C	D	E	F	G	H	J	K	L	M	N	P	R	S	T	U	V	W	X	Y
1/2, 3/4	1 3/8	1 1/8	7/8	1/8	3/8	1/4	3/4	1/4	21/32	13/32	1/4	3/4	1	1 3/8	3/4	1/2	1 1/4	5/8	3/16	1/4-28	1/4	11/32	1/2
1 1/8	1 3/8	1 3/8	7/8	1/8	3/8	1/4	1	5/16	21/32	13/32	1/4	1	1 1/2	2	15/16	3/4	1 11/16	5/8	1/4	5/16-24	5/16	11/32	5/8

NOTE: ROD NUT INCLUDED ON ALL DIGIT-AIR TYPE CYLINDERS