

Models MTM/MTMR Swivel Mount Cylinders

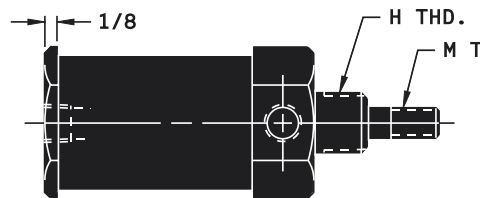

Models MSM/MSMR Nose Mount Cylinders

FOR MODELS MTM & MSM DOUBLE ACTING: A + STROKE
 FOR MODELS MTMR & MSMR SPRING RETURN: A + (STROKE X 2)
 FOR MODELS MTMR & MSMR UP TO 1/2" STROKE SPRING RETURN: A + (STROKE + 1")

Bore Size	A	B	C	D	E	H	J	K	L	M	R	S	T
1/2	2 ¹ / ₁₆	1 ¹ / ₄	13 ¹³ / ₁₆	1/2	9 ⁹ / ₁₆	1/2-20	1/4	1/4	1/2	1/4-28	9 ⁹ / ₁₆	3/4	3/4
3/4	1 ⁹ / ₁₆	1 ¹ / ₄	13 ¹³ / ₁₆	1/2	9 ⁹ / ₁₆	5/8-18	1/4	1/4	1/2	1/4-28	9 ⁹ / ₁₆	1	3/4
1 ¹ / ₈	1 ⁹ / ₁₆	1 ⁵ / ₁₆	15 ¹⁵ / ₁₆	9 ⁹ / ₁₆	5 ⁵ / ₈	5/8-18	3/8	5 ⁵ / ₁₆	1/2	5 ⁵ / ₁₆ -24	5 ⁵ / ₈	1 ³ / ₈	3/4

Porting for all sizes is 1/8" N.P.T.F.

NOTE: For cylinders with bumpers, contact factory for stock stroke sizes and add 1/2" to Dimension "A" for each bumper. For cylinders with switches, contact factory for number of switches each stock stroke size can accommodate.

See Application Information for sensors and magnetic switch options, mounting accessories, special options, and ordering information.